

Introducing

# The Kekoa<sup>®</sup>

(The Warrior)

## Cabinet Collection

High Value Cabinetry Designed for Hawaii's Projects

### The Kekoa Cabinet Collection



Solid Lumber Face Frame Construction \* Birch, Oak



All Hardwood Plywood Construction  
Strong 3/4" Plywood Shelves



Beautiful Durable Finishes



Door Overlays  
• Standard (As shown)  
• Full Overlay

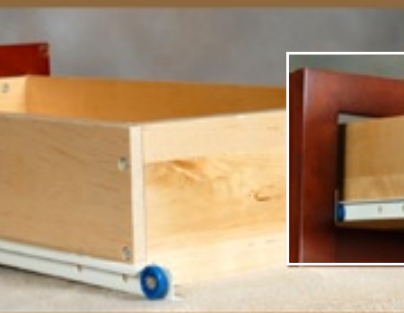

Solid 5/8" Hardwood Drawer Parts Standard  
• Side Mounted Epoxy Slides  
• Dovetail Upgrade Available  
• Undermount/Full Extensions Available



## Honsador Lumber

Available Statewide

### The Kekoa Cabinet Collection

**Shaker Style**



**Shaker Style**

Enhanced with grooves



Finished in Honsador's Exclusive  
**"Waimea Sea Salt" Stain Finish**



Natural Birch/Raised Panel Style



Natural Oak/Raised Panel Style

## Sizes and Types

### Base Cabinets

B09-B48

### Base 3 or 4 Drawer Cabinets

BD12-BD24

### Base Corner Cabinets

BBC, EZR, Lazy Susan

### Sink Base Cabinets

SB24-48

### Wall Cabinets

WO930-W4230

### Diagonal Corner Wall Cabinets

### Wall Appliance Cabinets

12", 15", 18" High  
by various widths

### Microwave Cabinets

### Vanity Drawer Base Cabinets

VBD12-24

### Vanity Sink Base Cabinets

VS24-48

### Vanity Cabinets

VC12-48

### Utility Tall Cabinets

18" and 24" wide

### Tall Oven Cabinets

30" and 33" wide

### Accessories

Crown & Scribe Molding

Finished End & Toe Kicks

Wall and Base Fillers

Refer & Dishwasher end panel

Custom sizes and types available

## Islander Granite



### Beautiful Granite Offerings

In stock:

- 6 colors to choose from
- Vanity tops with integral bowls
- Kitchen depth blanks, Bullnosed
- Bar Tops with 4 side Bullnose
- Large slabs
- Full custom fabrication
- Third party on-site install

### Excellent Project level capacity

Projects are imported directly from  
Factory to Jobsite in easy to handle crates  
Always view actual samples for color range

# The Kekoa Cabinet Collection

## Why The Kekoa Cabinet Collection?

**Kekoa**, the **Strong, Brave, Courageous Soldier** epitomizes the motivation for creating this collection. This cabinet, also dubbed "The Warrior", is our project level cabinet line. We engineered "The Warrior" to be tough, strong and lighter but equipped with features and hardware that would allow it to function and look better than its market peer group, while being priced right. Indeed, **Kekoa** is designed and priced for project work but quality has been built in and more importantly that quality is assured by Honsador's "**QualityTouch™**" program. We insist on quality and assure it by placing a Honsador representative at the manufacturing source. Only product that passes the "**Quality-Touch™**" makes it to Hawaii and your project. **Kekoa** is a collection that will stand tall when compared to other project level cabinet lines. Check out the features shown below:



Typical 30" high wall cabinet

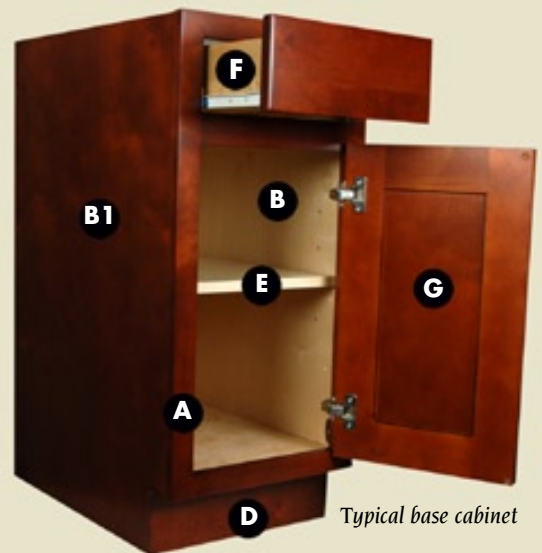

Typical base cabinet

### Part A

3/4" x 1-1/2" solid hardwood face frame glued and doweled.

### Part B

@ interiors - 1/2" thick hardwood plywood sides with real wood veneer and natural finish, standard. Thicker plywood and other stain finishes available.

### Part B1

Sides are prefinished and require no finished panels due to concealed joinery.

### Part C

Base and wall cabinets have a 3/16" thick back surrounded by 1/2" Hardwood plywood frame for solid attachment to walls.

### Part D

Base Cabinet Toe kicks are made from 1/2" Hardwood plywood and are covered after installation with a continuous 8 ft. prefinished, 3/16" Hardwood plywood Toe Kick Cover.

### Part E

Heavy duty, 3/4" thick furniture grade, fully banded, full depth adjustable shelves on chrome shelf supports.

### Part F

Drawer boxes are constructed from 5/8" solid, edge glued, clear, Birch or Basswood hardwood sides with 1/4" drawer bottom. Joinery features rabbeted corners, glued and screwed together. Drawer slides are 75#, white, epoxy coated side mounted.

### Part G

Shaker recessed panel is 3/8" Hardwood plywood panel. Mortise and Tenon joinery.

*Assembly: Concealed (interior) cam locks, glue and staple (as needed). Finishes and color vary. View actual sample. All wood parts are natural and will have grain & color variations.*

**Oahu**  
91-151 Malakole Rd.  
Kapolei, HI 96707  
Ph: 808.682.2011

**Maui**  
250 Lalo Pl.  
Kahului, HI 96732  
Ph: 808.877.5045

**Hilo**  
100 Kukila St.  
Hilo, HI 96720  
Ph: 808.961.6000

**Kona**  
73-5580 Kauhola St.  
Kailua-Kona, HI 96740  
Ph: 808.329.0738

**Kauai**  
3371 Wilcox Rd.  
Lihue, HI 96766  
Ph: 808.246.2412



Exclusively Distributed by

# Honsador Lumber

[www.honsador.com](http://www.honsador.com)

© Copyright 2009 All Rights Reserved